

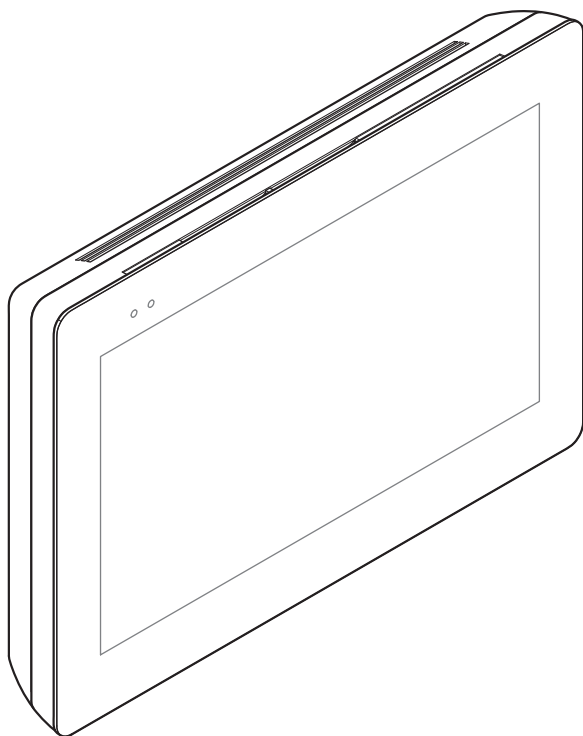

Wifi touch-screen speaker video-intercom

FA01680-EN



XTS 7 WH WIFI
XTS 7 BK WIFI
XTS 7 WH WFBF

INSTALLATION AND CONFIGURATION MANUAL

EN English

GENERAL PRECAUTIONS

- Read the instructions carefully before beginning the installation and carry out the procedures as specified by the manufacturer.
- Installation, programming, commissioning and maintenance must only be carried out by qualified, expert technicians and in full compliance with the applicable law.
- Before carrying out any cleaning or maintenance, disconnect the device from the power supply.
- Only use this product for its intended purpose. Any other use is hazardous. Came S.p.A. is not liable for any damage caused by improper, erroneous or unreasonable use.
- Only use soft, dry or slightly damp cloths to clean the device. Do not use any chemical products.
- Do not obstruct the ventilation or heat dissipation vents or slots.
- Do not expose the LCD screen to direct sunlight.
- General precautions for controlling the device remotely.
- Some features of the system may be managed using smartphones or tablets via the corresponding apps.
- For the system to be remotely controlled, the device must be connected to a home Wi-Fi network with internet access.
- This type of system requires a high-quality Wi-Fi signal to the device to function properly.
- The smartphone or tablet running the app must not block VoIP apps.

 Remotely controlling the device via the app means consuming your smartphone/tablet/home network's data traffic. The cost of this consumption is borne by the user.

- The product, in its original packaging supplied by the manufacturer, must only be transported in a closed environment (railway carriage, containers, closed vehicles).
- **If the product malfunctions, stop using it and contact customer services at <https://www.came.com/global/en/contact-us> or via the telephone number on the website.**

 The manufacture date is provided in the production batch printed on the product label. If necessary, contact us at <https://www.came.com/global/en/contact-us>.

 The general conditions of sale are given in the official CAME price lists.

LEGISLATIVE REFERENCES

This product complies with the applicable standards in force at the time of manufacturing.

RED

CAME S.p.A. declares that the product described in this manual complies with Directive 2014/53/EU and the Radio Equipment Regulations 2017.

The full EC declaration of conformity and UK Conformity Assessed (UKCA) marking information can be found at www.came.com.

CLEANING THE DEVICE

To clean the device, use a soft, slightly damp cloth only. Wet the cloth with water or an ammonia solution. Alternatively, use an oil-based soap (e.g. Marseille soap) or a gentle makeup remover (e.g. a cleanser or micellar water).

Always wipe the surface with a damp cloth (wet with just water) after cleaning. Never use alcohol-based solutions or solutions containing surfactants.

DECOMMISSIONING AND DISPOSAL

Dispose of the packaging and the device at the end of its life cycle responsibly, in compliance with the laws in force in the country where the product is used. The recyclable components are marked with a symbol and the material's ID marker.

THE DATA AND INFORMATION SHOWN IN THIS MANUAL ARE TO BE CONSIDERED AS SUBJECT TO CHANGE AT ANY TIME AND WITHOUT THE NEED FOR ANY ADVANCE WARNING.

MEASUREMENTS, UNLESS OTHERWISE INDICATED, ARE IN MILLIMETRES.

DESCRIPTION

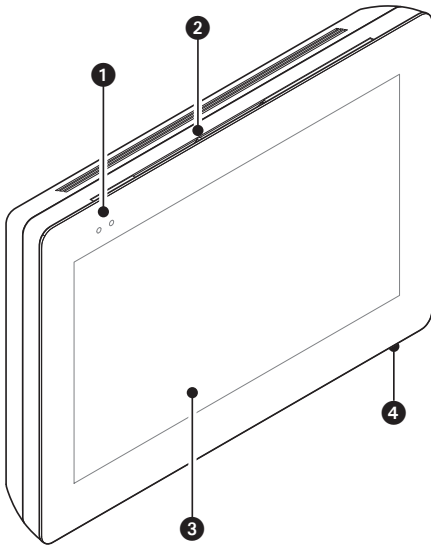

Full-touch speaker video-intercom for the X1 wall-hung system.

Description of parts

Front view

- ① Signaling LED
- ② Speaker
- ③ Touch-screen display
- ④ Microphone.

Rear view

- ⑤ Housing for the not-included Micro SD card (for future use).
- ⑥ Reset button. When pressed it reboots the device; this operation DOES NOT require any deleting of programming.

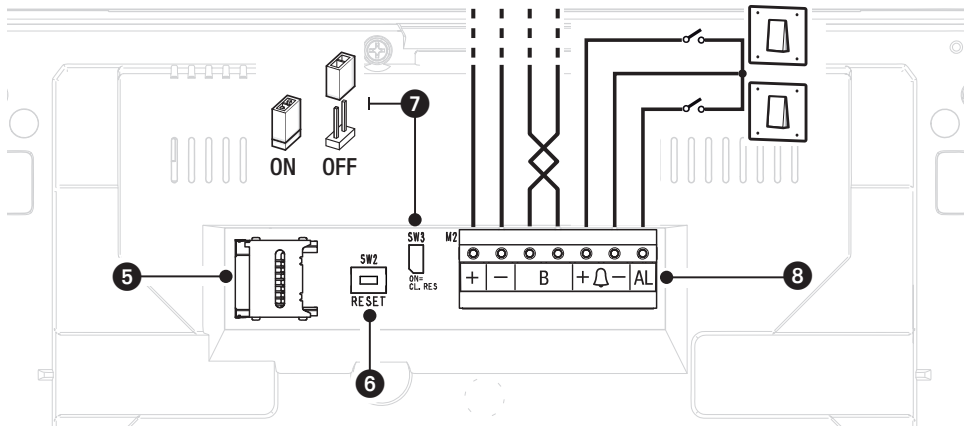

- ⑦ End-of-line resistor. Set the bridge only on the last of the line's devices.

⑧ Function of terminals

- Local power supply input
- B BUS-line input
- Landing call input
- AL Alarm input

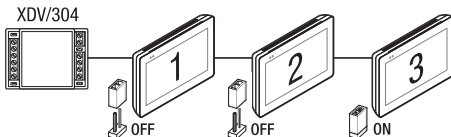

Technical data

Type	XTS 7 WIFI
local power supply (V DC)	14 to 18
Maximum draw (mA)	520
Current draw in stand-by mode (mA)	360
Stocking temperature °C*	-25 to +70
Operating temperature °C	0 to +40
Protection rating (IP)	30
Capacitive TFT Touch-screen Display (pixels)	1024 x 600
Standard wireless (IEEE)	802.11b, 802.11g, 802.11n
Wireless frequency filed (MHz)	2,412 - 2,472
Maximum transmission strength (dBm)	16
Wireless security	WPA/WPA2-PSK, WEP
Average life (hours)**	150,000

(*) Before installing the product, keep it at room temperature where it has previously been stored or transported at a very high or very low temperature.

(**) The average product life is a purely indicative estimate. It applies to compliant usage, installation and maintenance conditions. It is also influenced by other factors, such as climatic and environmental conditions.

INSTALLATION

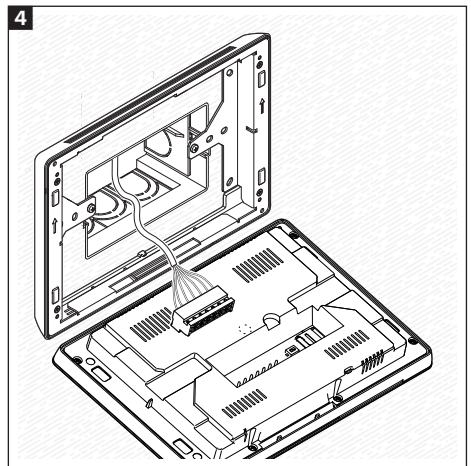
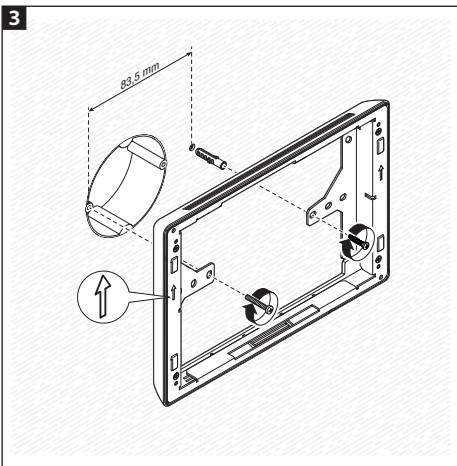
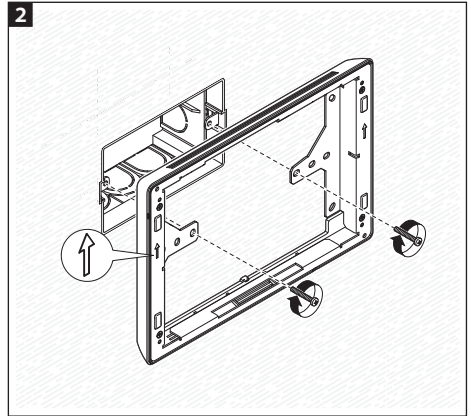
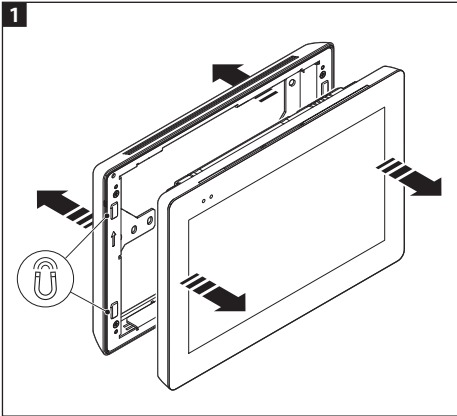
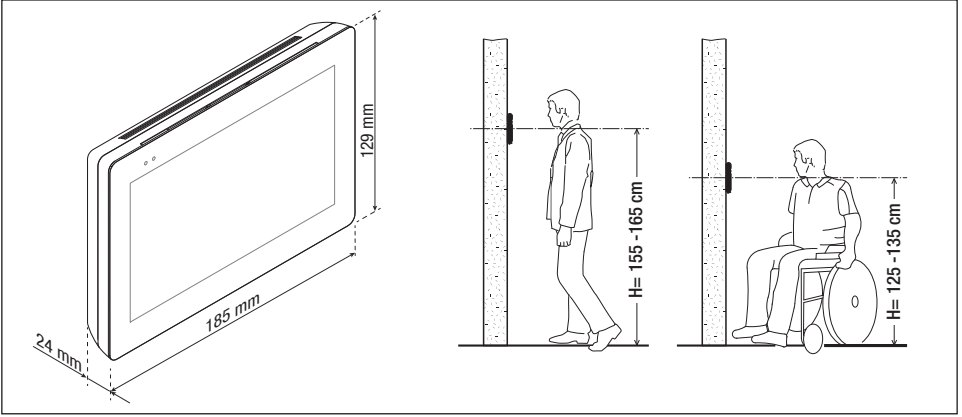

5

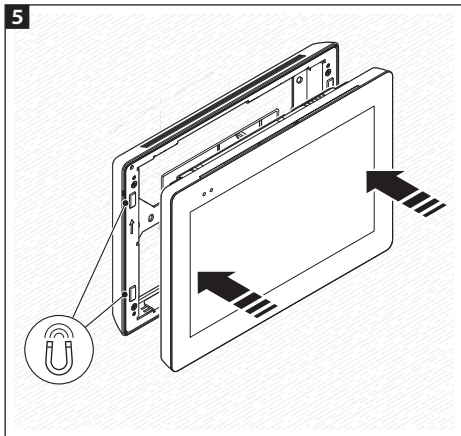





 To make the device's installation more solid, use the supplied screws and dowels to fasten the frame to the wall.

Notes on installing indoor receivers connected to the WiFi network

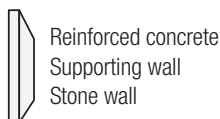
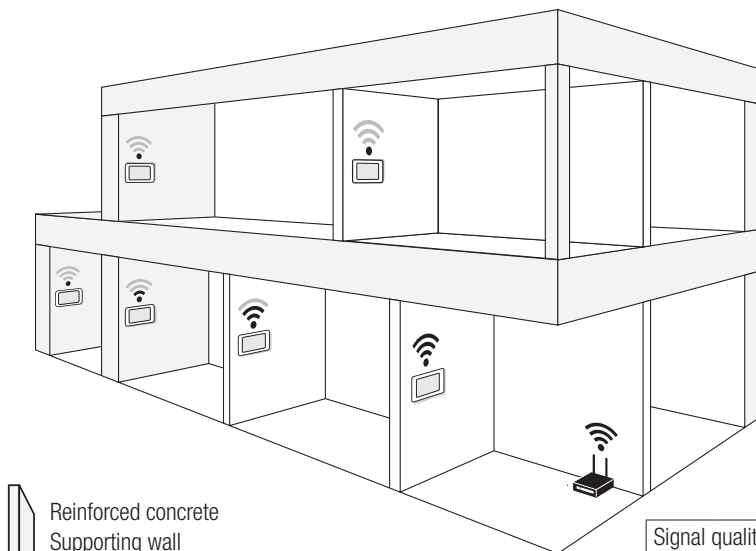
Install the indoor receiver: away from any metal objects that may interfere with the signal, or from any devices that generate magnetic fields. Install it in the same room as the router or have the least possible number of walls separating the router and the indoor receiver.

If the place chosen for installing the indoor receiver is not easily reached by a sufficiently intense WiFi signal, we suggest installing a signal regeneration processor which is easily bought on the open market.





Signal quality	
	Optimal
	Good
	Sufficient
	Insufficient

Examples of installation

Installing four indoor receivers in one home.

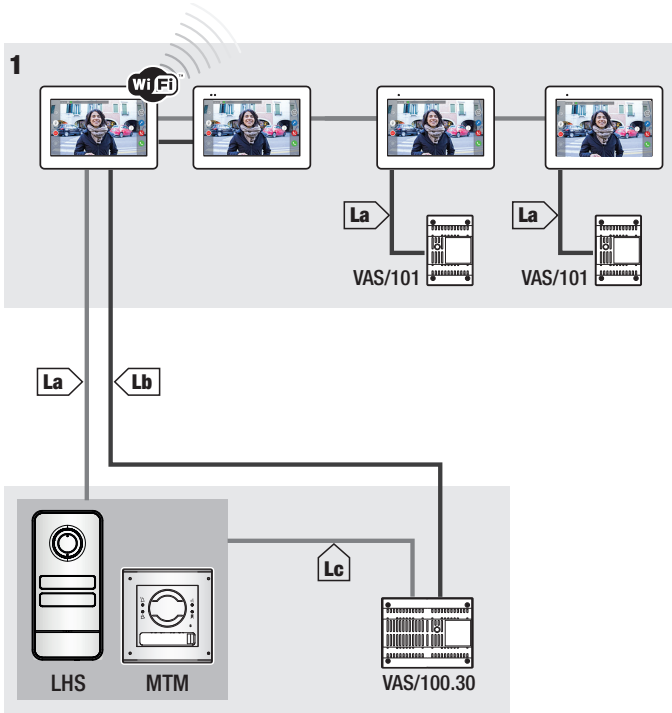
 The WiFi connection needs only to be active on one indoor receiver. The Apps are associated to the indoor receiver that has an active Wifi connection.



	VCM/1D	VCM/2D	UTP/CAT 5	2x1.5mm ²
La	≤ 100 m	≤ 100 m	≤ 100 m	–
Lb	–	≤ 100 m	≤ 50m *	–
Lc	≤ 75 m	–	–	≤ 100 m

* Use a pair of wires for each single power-supply conductor.

Device installed in several homes with different types of power-supply units.

In a home where several indoor receivers are installed, the WiFi connection need only be active on one of the receivers. The Apps are associated to the indoor receiver that has an active Wifi connection.

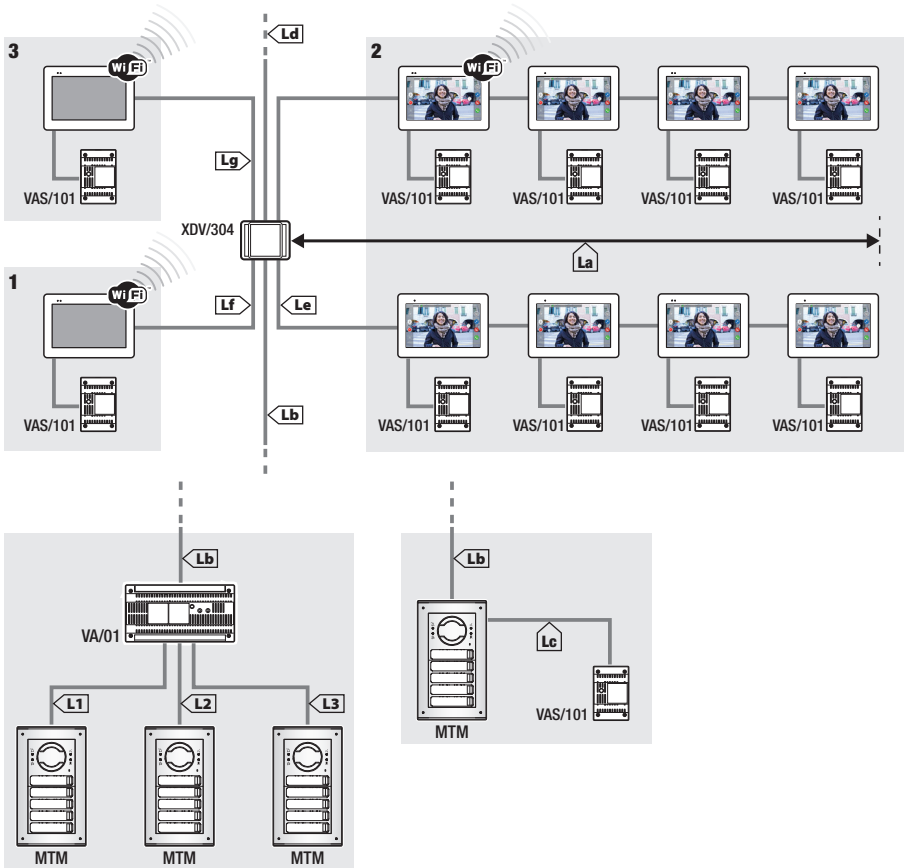

A maximum of 5 Monitors can be connected enter/exit mode at each output of the XDV/304 distributor

Each single call can activate a maximum number of 8 devices.

	VCM/1D	VCM/2D	UTP/CAT 5	2x1.5mm ²
La+Lb	≤100 m	–	≤100 m	–
Lc	≤75 m	–	–	≤100 m
L1, L2, L3	–	≤100 m	–	–
La + Lb + L1 (L2, L3)				≤150 m
La + Lb + Lc + Ld + Le + Lf + Lg + (L1, L2, L3)*				≤600 m

*In the count, only consider the longest distance among those measured from the indoor receiver to the power supply unit.

Installed at a duplex home, where each home has a device

The Apps are associated to the indoor receiver that has an active Wifi connection.

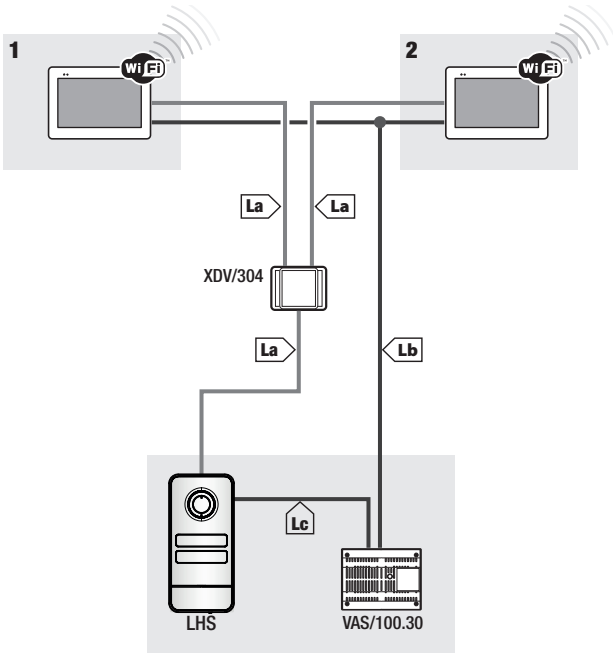

	VCM/1D	VCM/2D	UTP/CAT 5	2x1.5mm ²
La	≤ 100	≤ m 100	≤ m 100	–
Lb	–	≤ m 100	≤ m 50*	–
Lc	≤ m 75	–	–	≤ m 100

* Use a pair of wires for each single power-supply conductor.

Greatest number of devices that can be connected to the indoor receiver that has the active WiFi connection

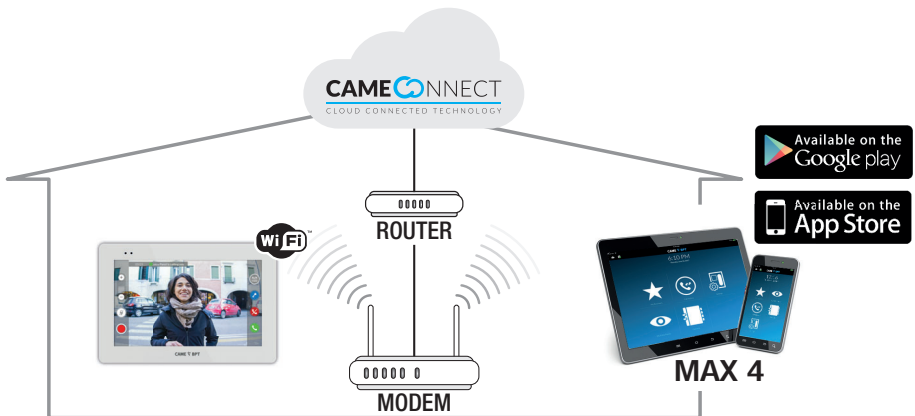

COMMISSIONING

Once the cables are laid and connected, program the essential function for operating the device.

Scroll the available pages.

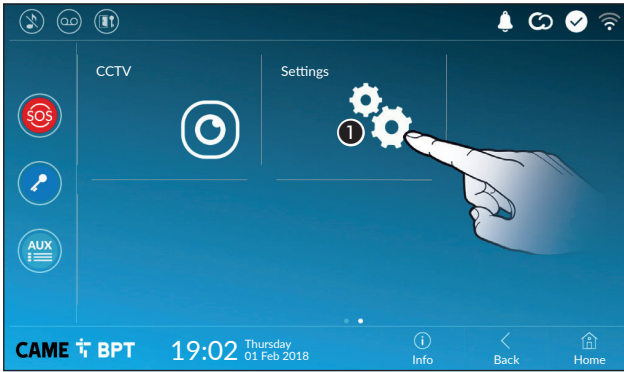

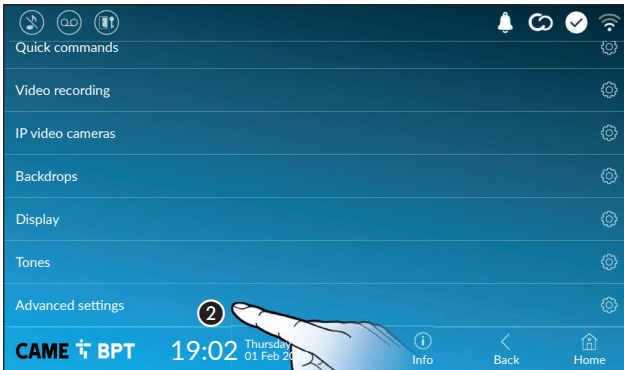

Select item 1.

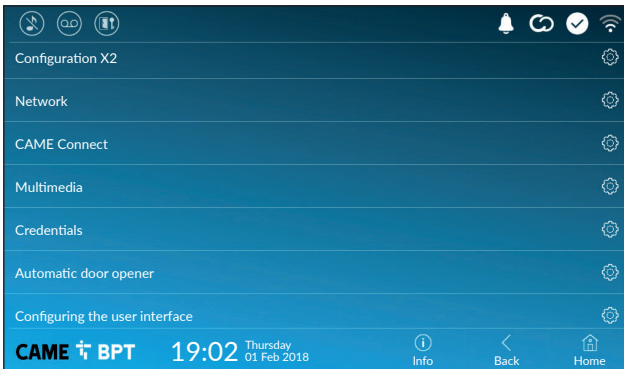

Scroll the list.
Select menu item 2.

Advanced settings



 This section requires specific know-how in operating the video-intercom system. Wrong settings may cause partial or even total malfunctions; that is why the editing of some parameters is allowed only after entering the installer password; the default password is 112233).

Configuration X2

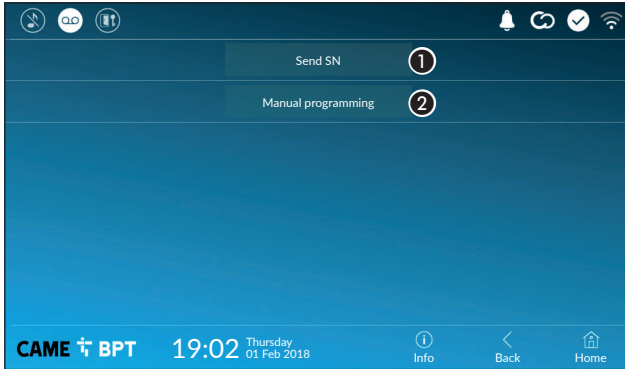

❶ This button is for sending the SN (serial number) to the Pcs/Xip software during the programming steps.

❷ This button takes you to manual programming of the device.

📖 The complete manual programming procedure for the call is printed in the literature that is issued with the indoor receivers.

Network



❸ This button is for enabling WiFi communication.

This icon  shows that the WiFi connection is active, enabling the network-settings sections below.

❹ Lets you choose the type of address from:

DHCP

The device's IP address is assigned by the DHCP server; if there are no special needs, this mode lets you continue with the settings without adding any additional data.

Static

The device's IP address is manually assigned.

❺ If you have chosen a static IP address, enter the device's IP, which must belong to the same subnet as that of the router and of the other connected devices.

❻ If the netmask is different from the default one, provide the proper netmask.

❼ Provide the default gateway for your network.

❽ Enter a valid DNS address to have the CAMEConnect connection (for example, 8.8.8.8.).

📖 If a DHCP server is also present, the static address selected must not be among those included in the DHCP pool.

📖 For devices configured as a Master it is advisable to assign a static IP address. Instead if the address is generated by a DHCP server, check that the IP address is assigned on the basis of the MAC ADDRESS of the device or that the lease time is very high.

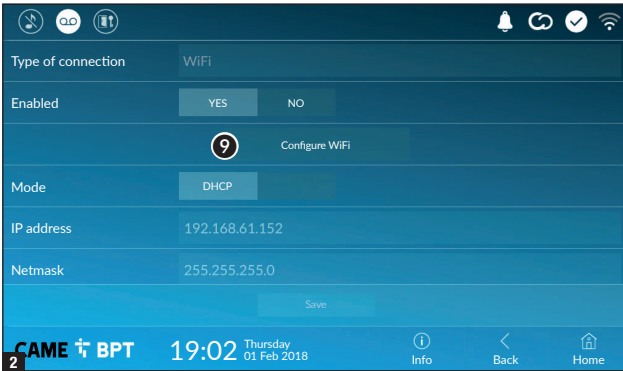

9 Once you have chosen the connection mode, the button is for selecting and setting up a Wifi network.

Every 30 seconds the device scans for available networks.

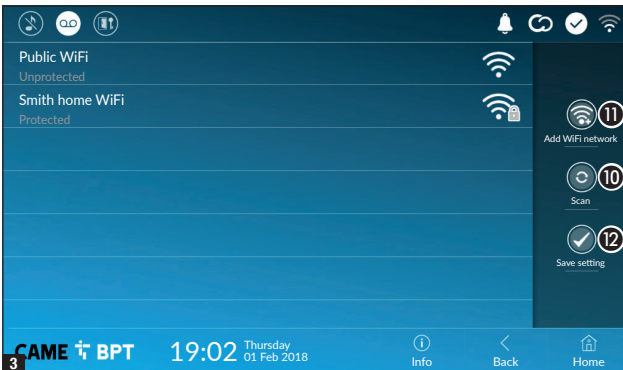

3 The page shows the detected networks; to manually scan for networks, touch the 10 button.

Select a network to connect to. If the network is unprotected the connection will be immediate.

If the network is protected, enter the password for the WiFi network to get access.

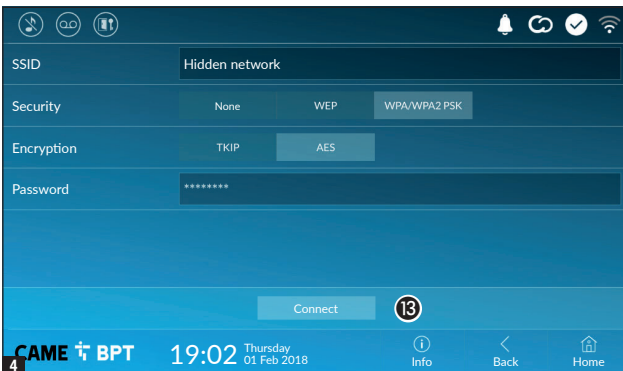

Press button 12 to save the configuration

To connect to a WiFi network with a hidden SSID, touch this button 11.

On the page provided you can enter an SSID, that is, network name, type of security, encryption and password; when required.

To connect, touch this button 13.

Press button 12 to save the configuration

CAME Connect

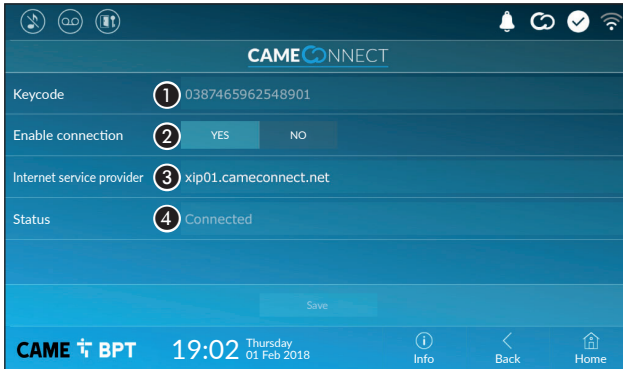

③ URL of the service for remote calls (the default one is xip01.cameconnect.net)

④ It shows the state of the connection.

① Device's univocal code.

② For enabling or disabling the VoIP remote control of the video-intercom call.

The factory settings require that the connection to CAME Connect be enabled.

 The CAME Connect connection must be active to receive calls over the App.

Multimedia

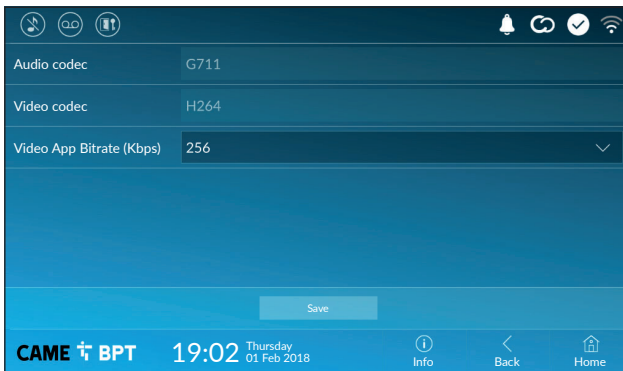

This window lets you configure the maximum BITRATE that the device can handle, while choosing among the available values.

 The greater the BITRATE values, the better the video quality, but also the greater the data bandwidth occupied in UPLINK.

If the video on the App is not fluid or deteriorated, set the lower BITRATE values.

Credentials

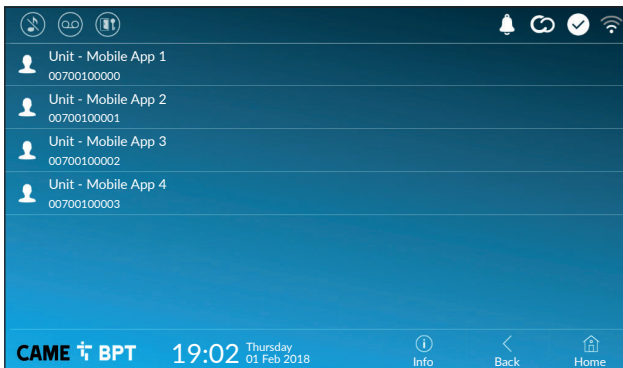

The window lets you view the credentials of the four users enabled to connect to the device via mobile devices.

Touch the user you want to access the screen that lets you assign or edit an access password.

Automatic door opener

This function, which is especially useful for businesses, lets you automatically open the entrance once the call-button is pressed on the entry panel. The activation of this function can be programmed to schedule time slots and days of the week.

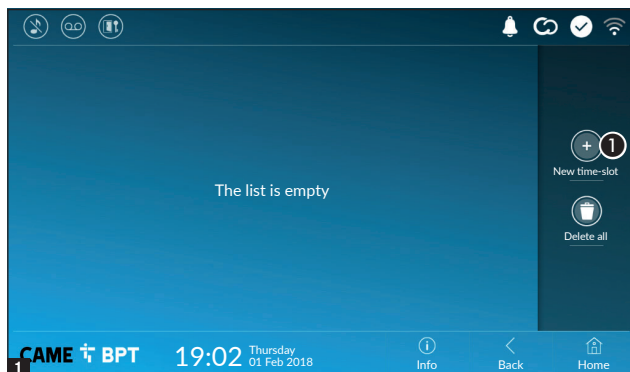

1 Touch the button to add a new time slot.

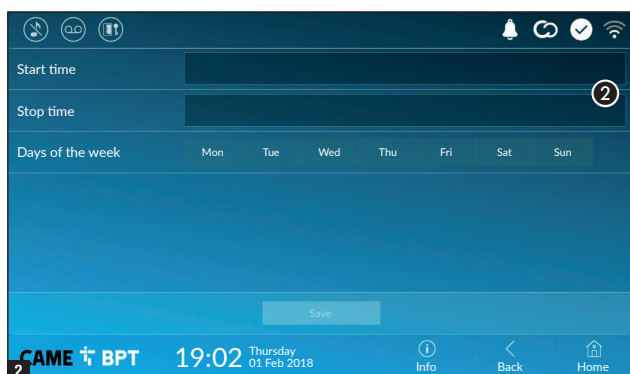

2 Touch the empty sections and in the pop-up window set the start and finish time of the time-slot for activating the function.

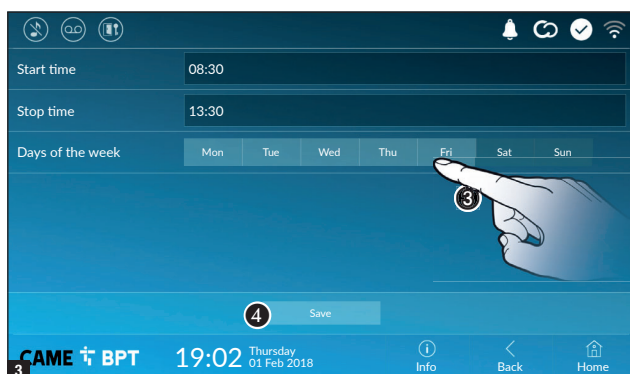

3 Touch the days of the week during which the time-slot needs to be active.

4 Touch this button to save the time-slot you have just created.

Create other new time-slots and touch the **Save** button to add them to the list.

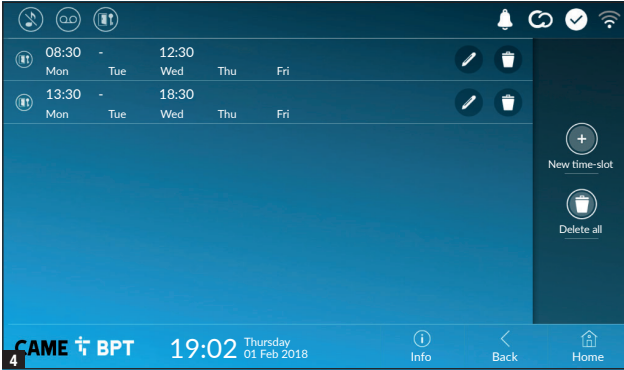

- ✎ For editing the selected element.
- 🗑 For eliminating the selected element.

Touch the **Back** button to return to the list of configurable parameters.

Configuring the user interface

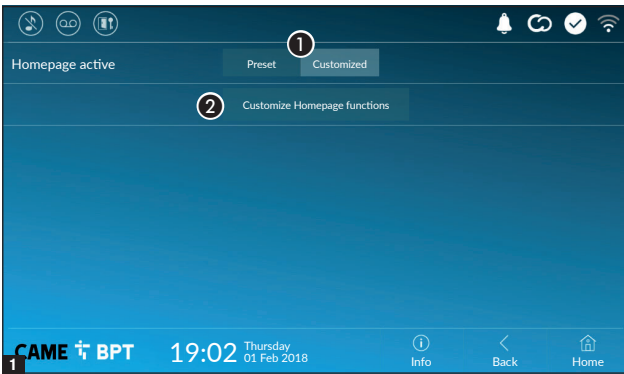

This section is for customizing the appearance of the homepage.

- 1 Select the type of homepage that you wish to see.
- 2 Touch the button to create a customized homepage.

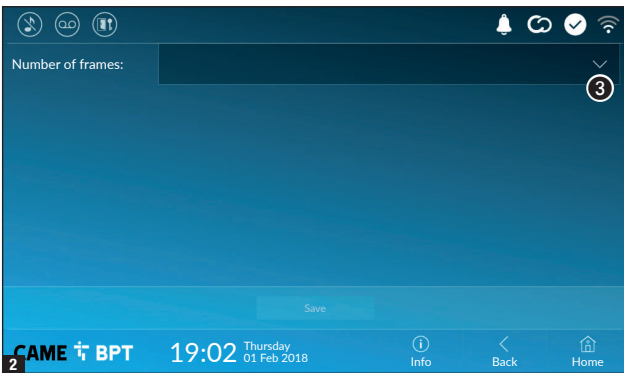

- 3 From the drop down menu select the total number of frames that will make up the main page.

📖 Each page contains at most six frames; the last one is always the configuration frame.

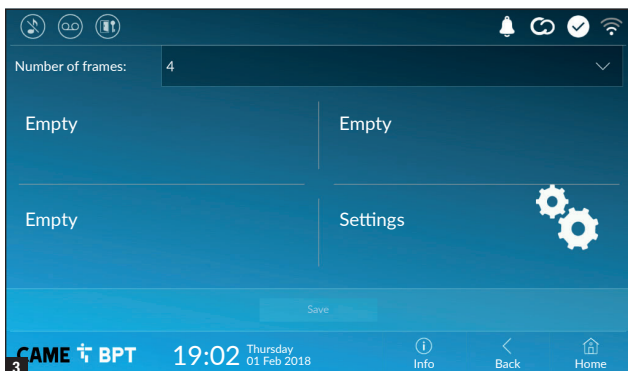

Touch each of the empty sections and use the drop-down menu to select the content that you want to assign to the section.

Save the setting by touching the **Save** button.

Maintenance

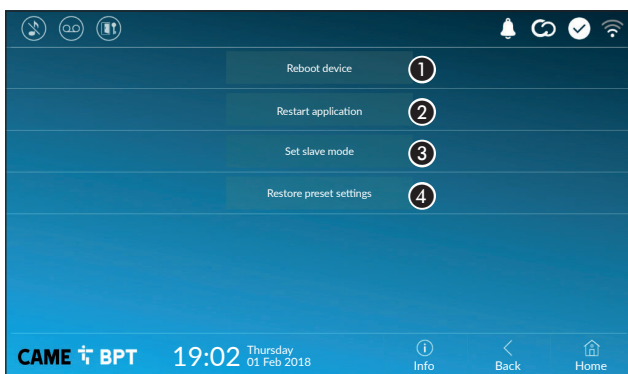

(administrator password required; the default password is 112233).

① Touch the button to reboot the indoor receiver.

② Touch the button to reboot only the application that runs the indoor receiver.

📖 The factory settings require that the indoor receiver operate in "master" mode. If the system features several indoor receivers, that answer the same call within a home, only one of these must operate in "master" mode. The others must operate in "slave" mode.

③ Touch the button to set the indoor receiver to "slave" mode.

④ Touch the button to return all the local settings to the default factory settings.

SETTINGS AVAILABLE ONLY FROM WEB PAGE

The web pages, in addition to allowing the configuration of most of the parameters that can be set by the interface of the receiver, allow provide some additional functions illustrated in this section.

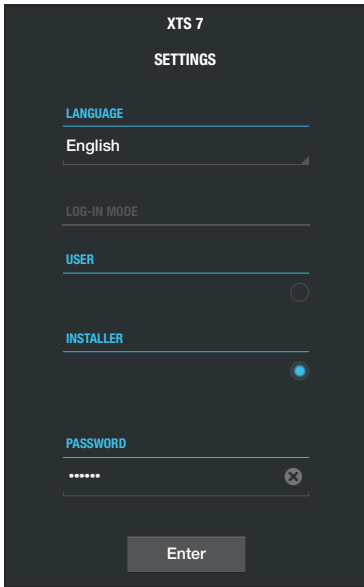

Type the address of the device in the browser address bar (Chrome, Firefox, Safari).

Select the [INSTALLER] access option and enter the password, which is set to "112233" by default, to access the settings windows.

 When accessing with "User" credentials (default password 123456) only lets you browse the pages that follow, except the user's sections.

 There is no scroll bar on the right on the settings web pages. To scroll through the pages, press and hold down the left-hand mouse button and drag. On a smartphone or tablet, drag your finger down the screen.

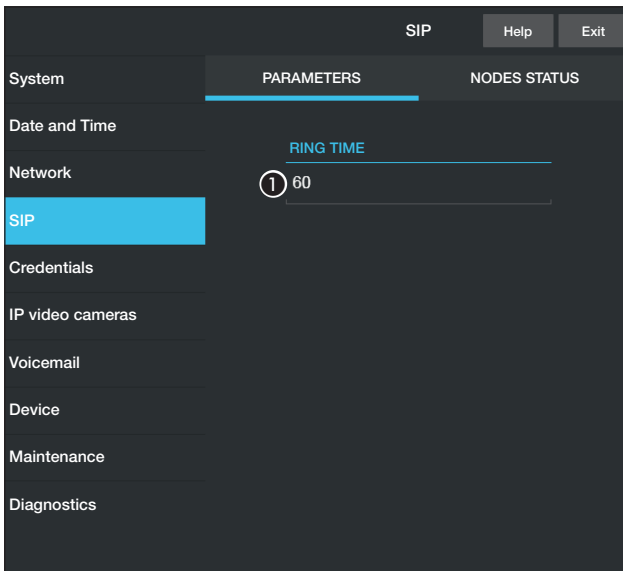

SIP

Characteristics

The ring time is the time after which the incoming call is interrupted.

 Add the ring time expressed in seconds.

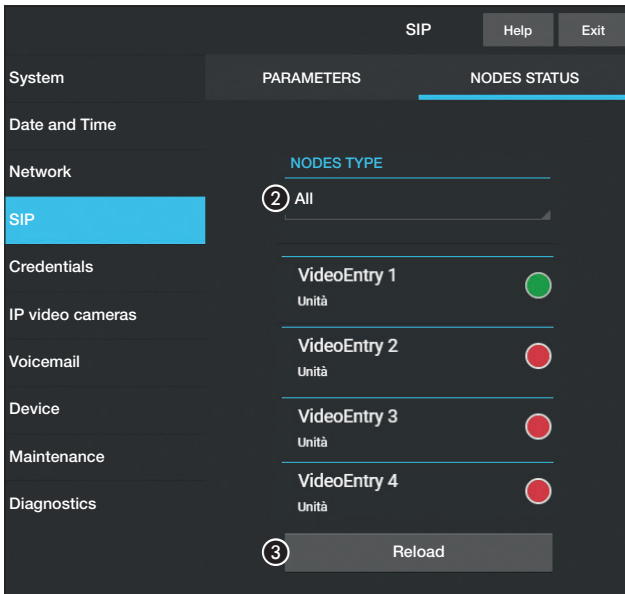

Node status

On master receivers, through this window it is possible to view the connection status of the SIP nodes.

② Choose the type of SIP nodes for which you want to view the status.

Red dot = Node not connected or being connected.

Green dot = Node connected and working.

③ Update the node status view.

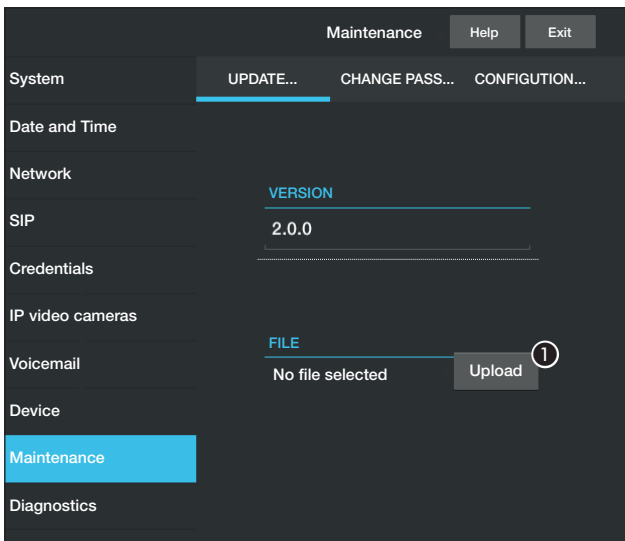

Maintenance

Update

This window is for updating the device's firmware, by proceeding as follows:

① Press the button, select the file containing the firmware update on your computer, and start the process.

Password change

In this window it is possible to change the password used to access.

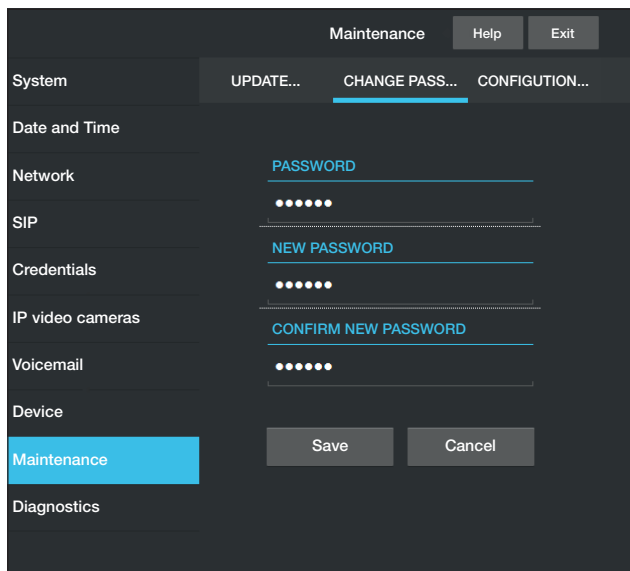

Diagnostics

❶ This section brings together statistical data on the operation of the device.

❷ The section lets you generate file that contain data useful for technical servicing aimed at finding any malfunctions.

❸ Lets you choose the accuracy and type of LOG files to collect.

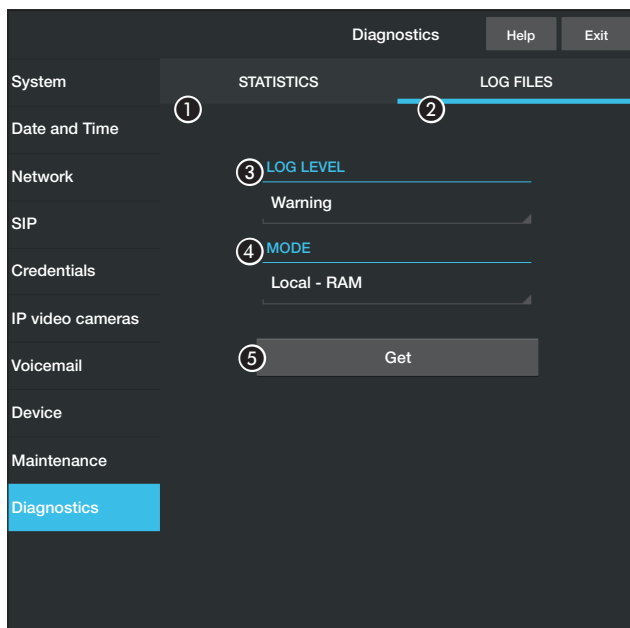

❹ Lets you choose where to save the LOG files from:

Local-RAM: the file is saved in the non-permanent memory of the device

Local-FLASH: the file is saved in the internal memory of the device (attention!, the capacity is limited)

Remote: the file is saved on a remote server where the IP address must be entered.

❺ It starts recovery of the log file.



CAME.COM

CAME S.P.A.

Via Martiri Della Libertà, 15
31030 Dosson di Casier - Treviso - Italy
tel. (+39) 0422 4940 - fax. (+39) 0422 4941
info@came.com - www.came.com